

RUUMI product collection

# LERRROA



THE RUUMI PRODUCT COLLECTION BRINGS  
REBELLION AND ELEGANCE TO INTERIORS.  
THE MINIMALIST CONCEPT, THE NOVEL  
COMBINATION OF STEEL CONSTRUCTIONS  
AND PRECISELY PROCESSED SHELVES MAKE  
THE USED SUSTAINABLE MATERIALS STAND OUT.

Products of the RUUMI collection:

- Shelf Smin – the price starts at 420 € (includes VAT)
- Shelf min – the price starts at 490 € (includes VAT)
- Shelf Smax – the price starts at 740 € (includes VAT)
- Shelf max – the price starts at 940 € (includes VAT)
- Cabinet – the price starts at 1 220 € (includes VAT)
- TV wall – the price starts at 3 300 € (includes VAT)
- Wall with desk – the price starts at 2 980 € (includes VAT)
- Library – the price starts at 920 € (includes VAT)
- Console table – the price starts at 600 € (includes VAT)
- Side table – the price starts at 930 € (includes VAT)
- Bench – the price starts at 1 040 € (includes VAT)

*All of our furniture can be adjusted to suit  
a specific project and the wishes of the  
investor, taking into account the dimensions  
of the product and the choice of decor.*

The final price depends on the chosen material  
and surface treatment of the construction.

Product delivery: 3 – 5 weeks  
(natural rust construction 4 – 7 weeks)

“We always combine aesthetics and functionality in our LERROA brand products. The added value of the materials used goes hand in hand with the original appearance. With the RUUMI collection, we let the naturalness show in the constructions as well. A great example is rust, which can bring a unique texture, a beautiful red-brown color and an unrepeatable pattern to the interior, or raw steel, which perfectly complements industrial interiors. These designs are authentic, timeless and age gracefully.”

*Authors of the collection:*

*Ing. Marek Povolný, Art Director LERROA*

*Ing. Jitka Vaněčková, Owner and CEO LERROA*

# SURFACE MATERIALS

- we let natural materials stand out

## BauBuche

BauBuche is made of beech wood from ecologically managed forests in Central Europe. The key difference between BauBuche and other laminated veneer lumber materials is the type of wood. The use of beech provides significantly higher strength and excellent surface quality. Thanks to the black bonding, BauBuche has a completely original, elegant and modern look.



# Valchromat

Valchromat is made of wood fibres colored in the production process. The fibres are impregnated with organic coloring agents and chemically bound to one another by a special resin which lends Valchromat unique features. Small wood fibers are visible on the surface that did not absorb the organic dyes. This peculiarity gives Valchromat its unique and natural appearance. Valchromat combines the natural properties of wood with the beauty of colors and textures. It is colored throughout the material, which allows the cutting edge to be left without subsequent treatment.



## DECORS



Grey

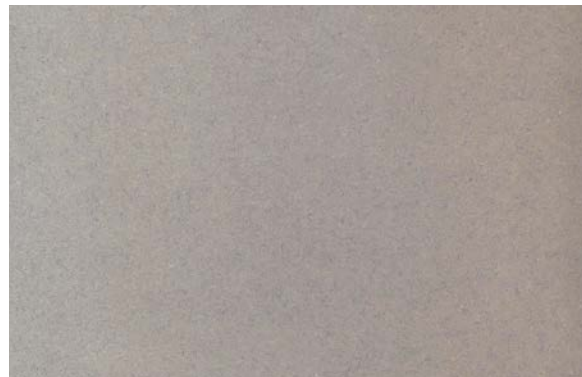

Light Grey



White Grey

More colors on request

# Rezign Veneer

Rezign Veneer is a recycled veneer made of textile waste such as denim, army clothing, but also from bio-based fibers such as flax, hemp and jute coffee bags. The fibers are first shredded into small pieces, which are then combined into felt. This is finally pressed using a biodegradable binder into a hard material - veneer. Using recycled materials, different batches of clothing or bio-based fibers may have different color outcomes. Therefore, the veneer is unique and one-of-a-kind.

## DECORS



White Denim



Jute Coffeebags



Flax



Army Green

# CONSTRUCTIONS – a combination of rawness, naturalness, beauty of colors and textures



**Rusty esthetics**  
naturally rusted steel construction

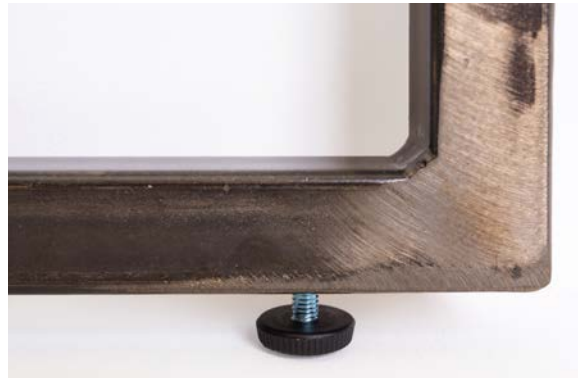

**Raw steel**



**Powder coating**

RAL shades in our offer:  
white (RAL 9016), yellow (RAL 1018), grey 1 (RAL 7047),  
grey 2 (RAL 7004), grey 3 (RAL 7000), grey 4 (RAL 7015),  
black (RAL 9005)

# Cabinet





## Cabinet

Minimalism, functionality, a combination of a solid and high-quality steel construction with natural materials unites the RUUMI collection of interior products. Create your own unique combination by choosing the material and surface treatment of the construction!

### Material:

- Valchromat  
colours: White Grey, Light Grey, Grey
- BauBuche

### Construction - surface treatment:

- Raw steel + transparent MAT lacquer
- Natural rust + transparent MAT lacquer
- Coloured varnish - white (RAL 9016), yellow (RAL 1018), grey 1 (RAL 7047), grey 2 (RAL 7004), grey 3 (RAL 7000), grey 4 (RAL 7015), black (RAL 9005)

Mounting legs M6, ø21 mm

Price starts at 1 220 € (includes VAT)

The final price depends on the chosen material and surface treatment of the structure.

Delivery: 3 - 5 weeks (natural rust construction 4 - 7 weeks)

NOTICE! RISK OF OVERTURNING - unsecured furniture can tip over. Attach the furniture to the wall using anchoring material suitable for the given type of wall. You hang the product on the anchor holes located on the back of the structure.

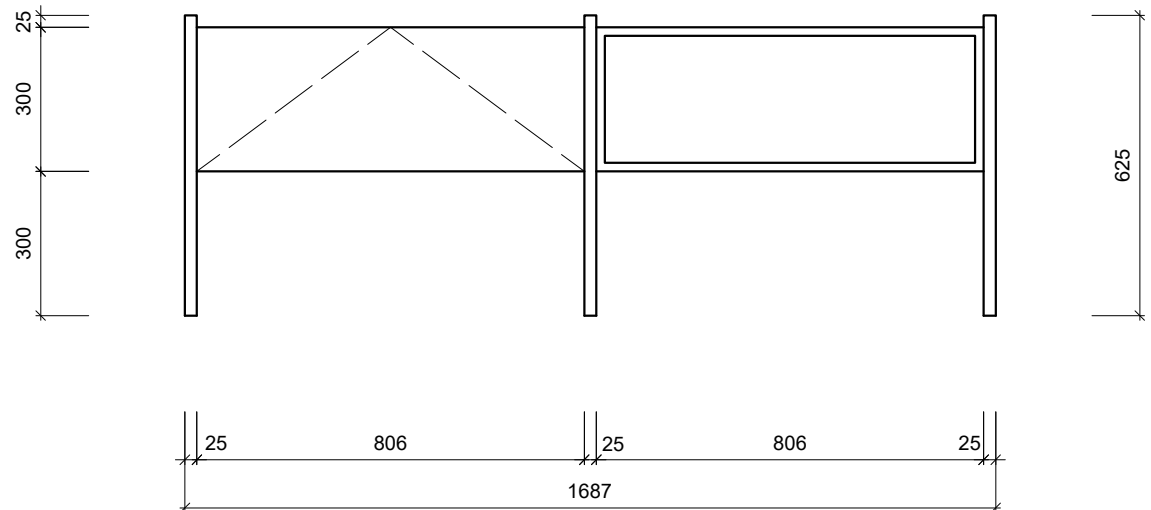

Product depth 375 mm

# TV wall



## TV wall

Minimalism, functionality, a combination of a solid and high-quality steel construction with natural materials unites the RUUMI collection of interior products. Create your own unique combination by choosing the material and surface treatment of the construction!

### Material:

- Valchromat  
colours: White Grey, Light Grey, Grey
- BauBuche – for shelves only
- Reznig Veneer – for shelves only  
colours: White Denim, Army Green, Jute Coffeebags, Flax

### Construction - surface treatment:

- Raw steel + transparent MAT lacquer
- Natural rust + transparent MAT lacquer
- Coloured varnish - white (RAL 9016), yellow (RAL 1018), grey 1 (RAL 7047), grey 2 (RAL 7004), grey 3 (RAL 7000), grey 4 (RAL 7015), black (RAL 9005)

Mounting legs M6, ø21 mm

Price starts at 3 300 € (includes VAT)

The final price depends on the chosen material and surface treatment of the structure.

Delivery: 3 - 5 weeks (natural rust construction 4 - 7 weeks)

NOTICE! RISK OF OVERTURNING - unsecured furniture can tip over. Attach the furniture to the wall using anchoring material suitable for the given type of wall. You hang the product on the anchor holes located on the back of the structure.

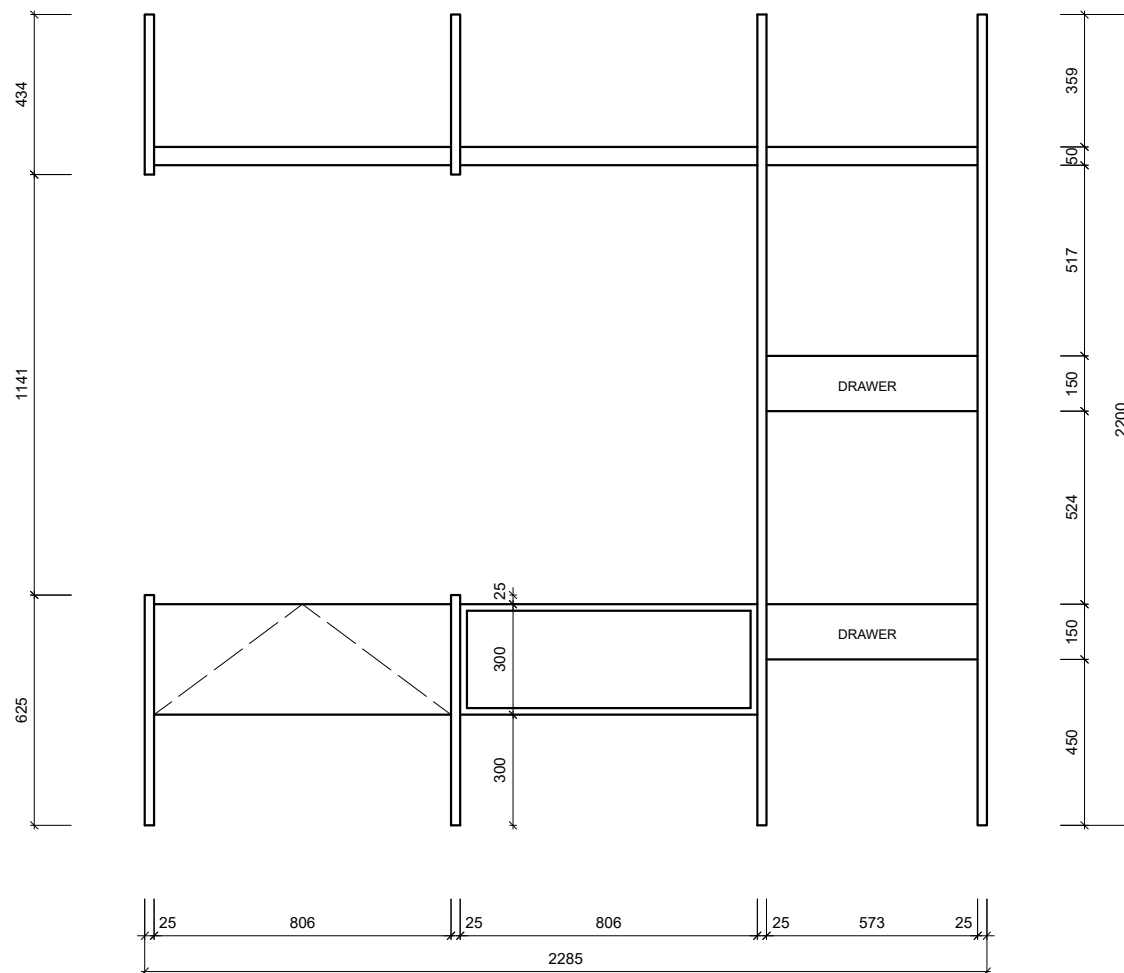

Product depth 375 mm

# Console table



## Console table

Minimalism, functionality, a combination of a solid and high-quality steel construction with natural materials unites the RUUMI collection of interior products. Create your own unique combination by choosing the material and surface treatment of the construction!

### Material:

- Valchromat  
colours: White Grey, Light Grey, Grey
- BauBuche
- Reznig Veneer  
colours: White Denim, Army Green, Jute Coffeebags, Flax

### Construction - surface treatment:

- Raw steel + transparent MAT lacquer
- Natural rust + transparent MAT lacquer
- Coloured varnish - white (RAL 9016), yellow (RAL 1018), grey 1 (RAL 7047), grey 2 (RAL 7004), grey 3 (RAL 7000), grey 4 (RAL 7015), black (RAL 9005)

Mounting legs M6, ø21 mm

Price starts at 600 € (includes VAT)

The final price depends on the chosen material and surface treatment of the structure.

Delivery: 3 - 5 weeks (natural rust construction 4 - 7 weeks)

NOTICE! RISK OF OVERTURNING - unsecured furniture can tip over. Attach the furniture to the wall using anchoring material suitable for the given type of wall. You hang the product on the anchor holes located on the back of the structure.

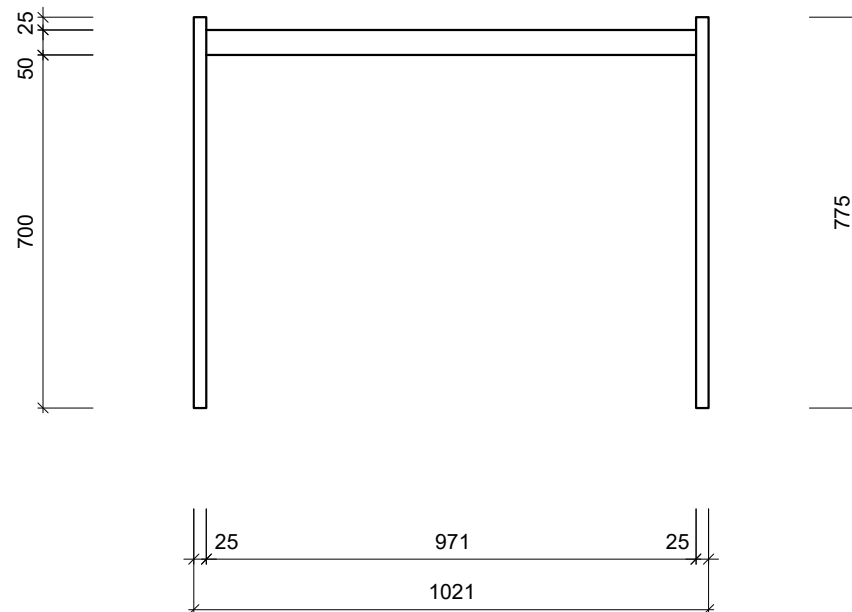

Product depth 375 mm

# Wall with desk



## Wall with desk

Minimalism, functionality, a combination of a solid and high-quality steel construction with natural materials unites the RUUMI collection of interior products. Create your own unique combination by choosing the material and surface treatment of the construction!

### Material:

- Valchromat  
colours: White Grey, Light Grey, Grey
- BauBuche – for shelves only
- Reznig Veneer – for shelves only  
colours: White Denim, Army Green, Jute Coffeebags, Flax

### Construction - surface treatment:

- Raw steel + transparent MAT lacquer
- Natural rust + transparent MAT lacquer
- Coloured varnish - white (RAL 9016), yellow (RAL 1018), grey 1 (RAL 7047), grey 2 (RAL 7004), grey 3 (RAL 7000), grey 4 (RAL 7015), black (RAL 9005)

Mounting legs M6, ø21 mm

Price starts at 2 980 € (includes VAT)

The final price depends on the chosen material and surface treatment of the structure.

Delivery: 3 - 5 weeks (natural rust construction 4 - 7 weeks)

NOTICE! RISK OF OVERTURNING - unsecured furniture can tip over. Attach the furniture to the wall using anchoring material suitable for the given type of wall. You hang the product on the anchor holes located on the back of the structure.

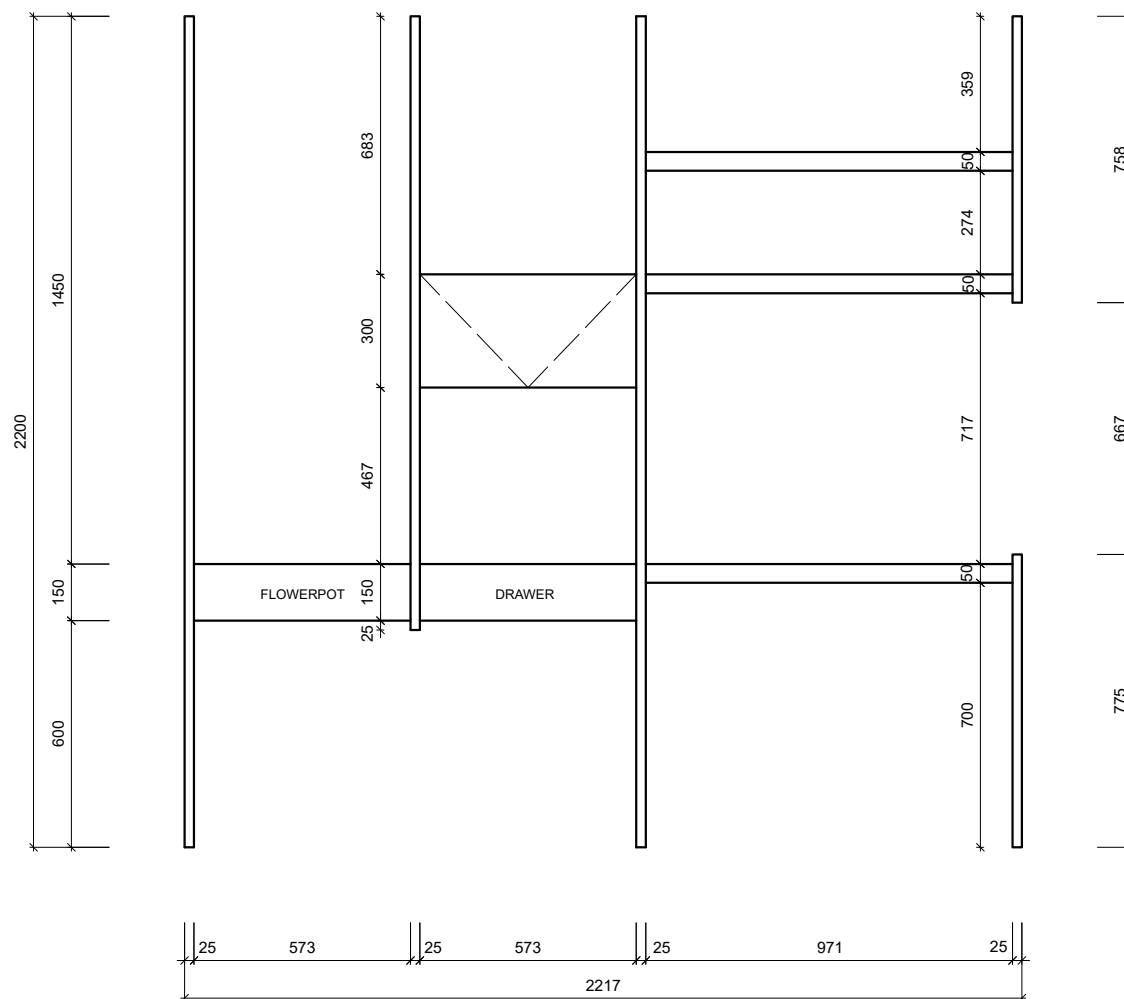

Product depth 375 mm

# Library





## Library

Minimalism, functionality, a combination of a solid and high-quality steel construction with natural materials unites the RUUMI collection of interior products. Create your own unique combination by choosing the material and surface treatment of the construction!

### Material:

- Valchromat  
colours: White Grey, Light Grey, Grey
- BauBuche
- Reznig Veneer  
colours: White Denim, Army Green, Jute Coffeebags, Flax

### Construction - surface treatment:

- Raw steel + transparent MAT lacquer
- Natural rust + transparent MAT lacquer
- Coloured varnish - white (RAL 9016), yellow (RAL 1018), grey 1 (RAL 7047), grey 2 (RAL 7004), grey 3 (RAL 7000), grey 4 (RAL 7015), black (RAL 9005)

Price starts at 920 € (includes VAT)

The final price depends on the chosen material and surface treatment of the structure.

Delivery: 3 - 5 weeks (natural rust construction 4 - 7 weeks)

NOTICE! Attach the furniture to the wall using anchoring material suitable for the given type of wall. You hang the product on the anchor holes located on the back of the construction.

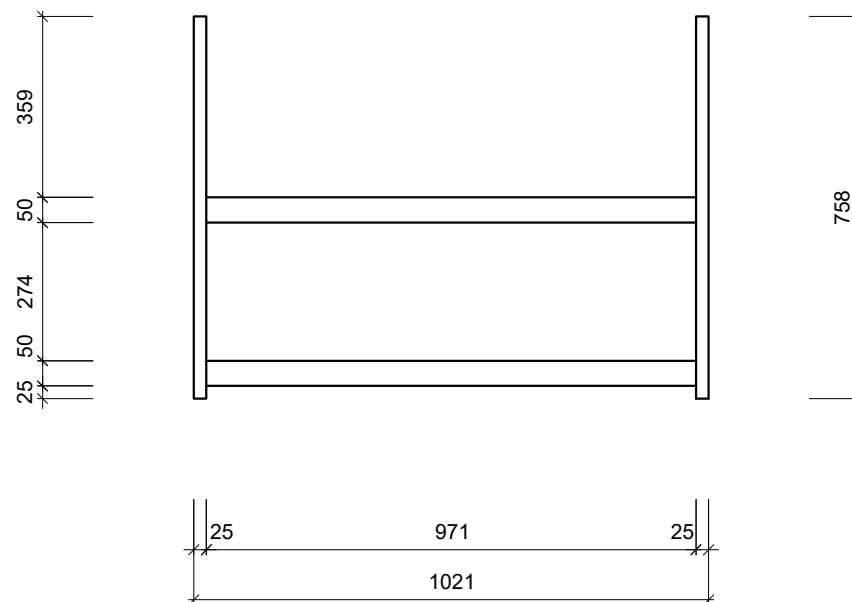

Product depth 375 mm

# Shelf Smin



## Shelf Smin

Minimalism, functionality, a combination of a solid and high-quality steel construction with natural materials unites the RUUMI collection of interior products. Create your own unique combination by choosing the material and surface treatment of the construction!

### Material:

- Valchromat  
colours: White Grey, Light Grey, Grey
- BauBuche
- Rezig Veneer  
colours: White Denim, Army Green, Jute Coffeebags, Flax

### Construction - surface treatment:

- Raw steel + transparent MAT lacquer
- Natural rust + transparent MAT lacquer
- Coloured varnish - white (RAL 9016), yellow (RAL 1018), grey 1 (RAL 7047), grey 2 (RAL 7004), grey 3 (RAL 7000), grey 4 (RAL 7015), black (RAL 9005)

Price starts at 420 € (includes VAT)

The final price depends on the chosen material and surface treatment of the structure.

Delivery: 3 - 5 weeks (natural rust construction 4 - 7 weeks)

NOTICE! Attach the furniture to the wall using anchoring material suitable for the given type of wall. You hang the product on the anchor holes located on the back of the construction.

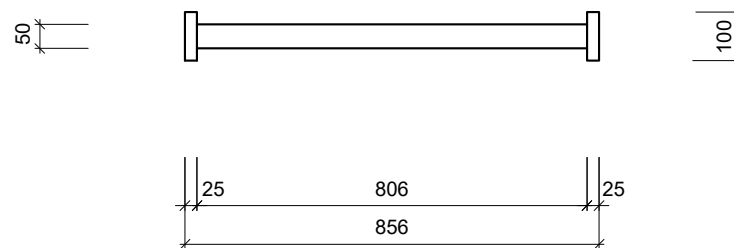

Product depth 260 mm

# Shelf Smax

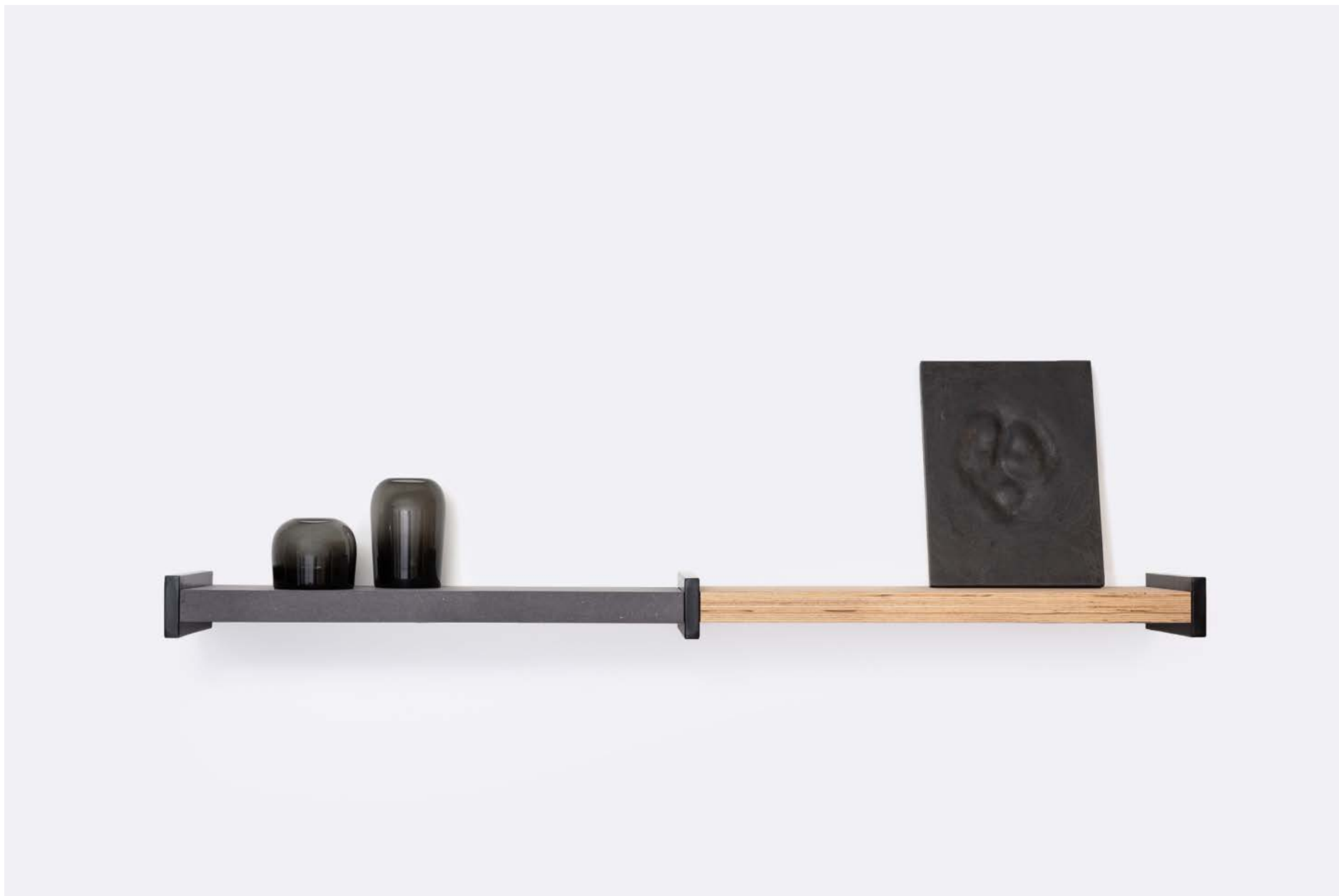

## Shelf Smax

Minimalism, functionality, a combination of a solid and high-quality steel construction with natural materials unites the RUUMI collection of interior products. Create your own unique combination by choosing the material and surface treatment of the construction!

### Material:

- Valchromat  
colours: White Grey, Light Grey, Grey
- BauBuche
- Reznign Veneer  
colours: White Denim, Army Green, Jute Coffeebags, Flax

### Construction - surface treatment:

- Raw steel + transparent MAT lacquer
- Natural rust + transparent MAT lacquer
- Coloured varnish - white (RAL 9016), yellow (RAL 1018), grey 1 (RAL 7047), grey 2 (RAL 7004), grey 3 (RAL 7000), grey 4 (RAL 7015), black (RAL 9005)

Price starts at 740 € (includes VAT)

The final price depends on the chosen material and surface treatment of the structure.

Delivery: 3 - 5 weeks (natural rust construction 4 - 7 weeks)

NOTICE! Attach the furniture to the wall using anchoring material suitable for the given type of wall. You hang the product on the anchor holes located on the back of the construction.

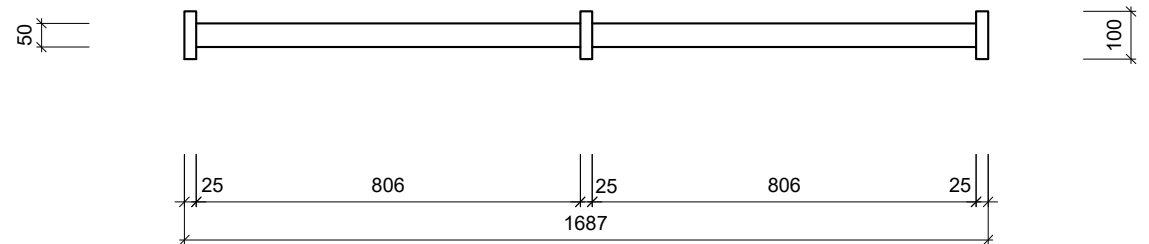

Product depth 260 mm

# Shelf min



## Shelf min

Minimalism, functionality, a combination of a solid and high-quality steel construction with natural materials unites the RUUMI collection of interior products. Create your own unique combination by choosing the material and surface treatment of the construction!

### Material:

- Valchromat  
colours: White Grey, Light Grey, Grey
- BauBuche
- Rezigyn Veneer  
colours: White Denim, Army Green, Jute Coffeebags, Flax

### Construction - surface treatment:

- Raw steel + transparent MAT lacquer
- Natural rust + transparent MAT lacquer
- Coloured varnish - white (RAL 9016), yellow (RAL 1018), grey 1 (RAL 7047), grey 2 (RAL 7004), grey 3 (RAL 7000), grey 4 (RAL 7015), black (RAL 9005)

Price starts at 490 € (includes VAT)

The final price depends on the chosen material and surface treatment of the structure.

Delivery: 3 - 5 weeks (natural rust construction 4 - 7 weeks)

NOTICE! Attach the furniture to the wall using anchoring material suitable for the given type of wall. You hang the product on the anchor holes located on the back of the construction.

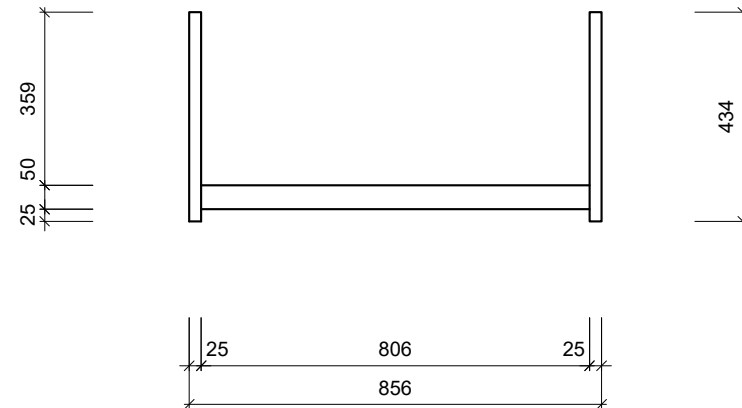

Product depth 375 mm

# Shelf max





## Shelf max

Minimalism, functionality, a combination of a solid and high-quality steel construction with natural materials unites the RUUMI collection of interior products. Create your own unique combination by choosing the material and surface treatment of the construction!

### Material:

- Valchromat  
colours: White Grey, Light Grey, Grey
- BauBuche
- Reznig Veneer  
colours: White Denim, Army Green, Jute Coffeebags, Flax

### Construction - surface treatment:

- Raw steel + transparent MAT lacquer
- Natural rust + transparent MAT lacquer
- Coloured varnish - white (RAL 9016), yellow (RAL 1018), grey 1 (RAL 7047), grey 2 (RAL 7004), grey 3 (RAL 7000), grey 4 (RAL 7015), black (RAL 9005)

Price starts at 940 € (includes VAT)

The final price depends on the chosen material and surface treatment of the structure.

Delivery: 3 - 5 weeks (natural rust construction 4 - 7 weeks)

NOTICE! Attach the furniture to the wall using anchoring material suitable for the given type of wall. You hang the product on the anchor holes located on the back of the construction.

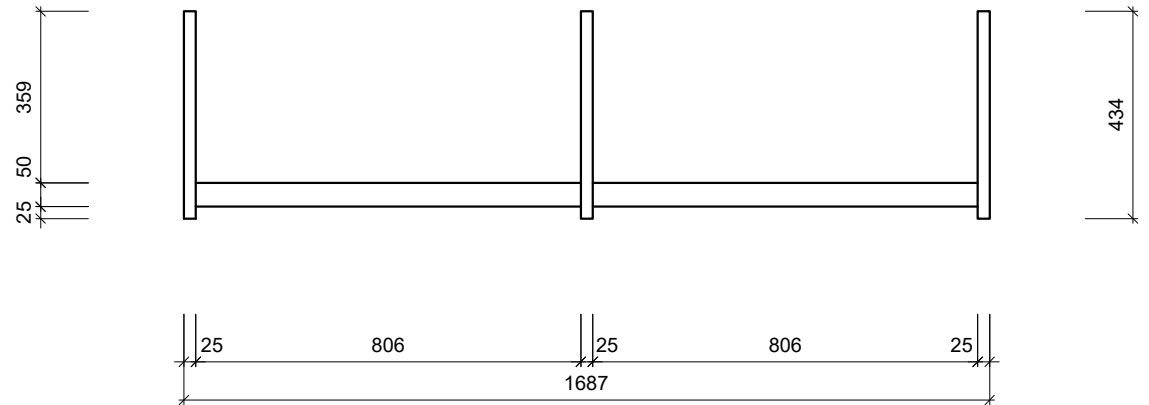

Product depth 375 mm

# Side table



## Side table

Minimalism, functionality, a combination of a solid and high-quality steel construction with natural materials unites the RUUMI collection of interior products. Create your own unique combination by choosing the material and surface treatment of the construction!

### Material:

- Valchromat  
colours: White Grey, Light Grey, Grey
- BauBuche
- Reziign Veneer  
colours: White Denim, Army Green, Jute Coffeebags, Flax

### Construction - surface treatment:

- Raw steel + transparent MAT lacquer
- Natural rust + transparent MAT lacquer
- Coloured varnish - white (RAL 9016), yellow (RAL 1018), grey 1 (RAL 7047), grey 2 (RAL 7004), grey 3 (RAL 7000), grey 4 (RAL 7015), black (RAL 9005)

Mounting legs M6, ø21 mm

Price starts at 930 € (includes VAT)

The final price depends on the chosen material and surface treatment of the structure.

Delivery: 3 - 5 weeks (natural rust construction 4 - 7 weeks)

NOTICE! RISK OF OVERTURNING - unsecured furniture can tip over. Attach the furniture to the wall using anchoring material suitable for the given type of wall. You hang the product on the anchor holes located on the back of the structure.

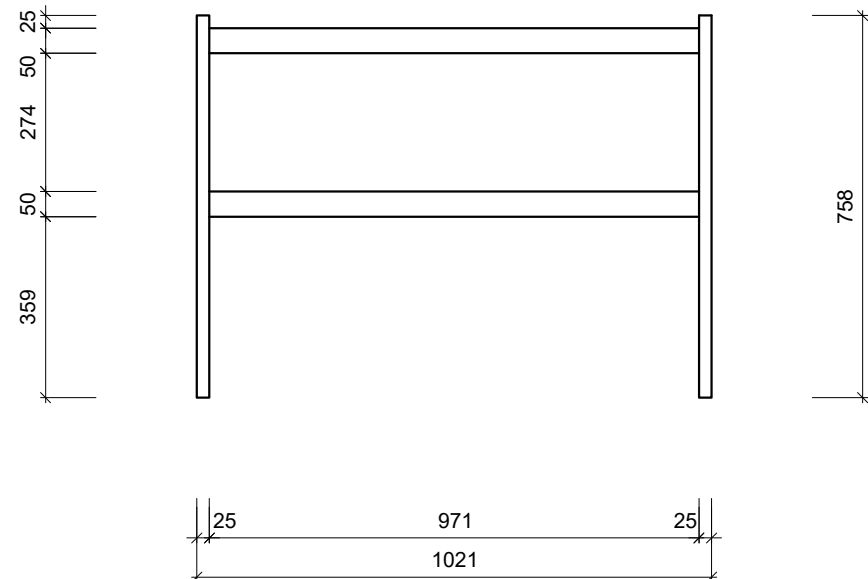

Product depth 375 mm

# Bench



## Bench

Minimalism, functionality, a combination of a solid and high-quality steel construction with natural materials unites the RUUMI collection of interior products. Create your own unique combination by choosing the material and surface treatment of the construction!

### Material:

- Valchromat  
colours: White Grey, Light Grey, Grey
- BauBuche
- Reznig Veneer  
colours: White Denim, Army Green, Jute Coffeebags, Flax

### Construction - surface treatment:

- Raw steel + transparent MAT lacquer
- Natural rust + transparent MAT lacquer
- Coloured varnish - white (RAL 9016), yellow (RAL 1018), grey 1 (RAL 7047), grey 2 (RAL 7004), grey 3 (RAL 7000), grey 4 (RAL 7015), black (RAL 9005)

Mounting legs M6, ø21 mm

Price starts at 1 040 € (includes VAT)

The final price depends on the chosen material and surface treatment of the structure.

Delivery: 3 - 5 weeks (natural rust construction 4 - 7 weeks)

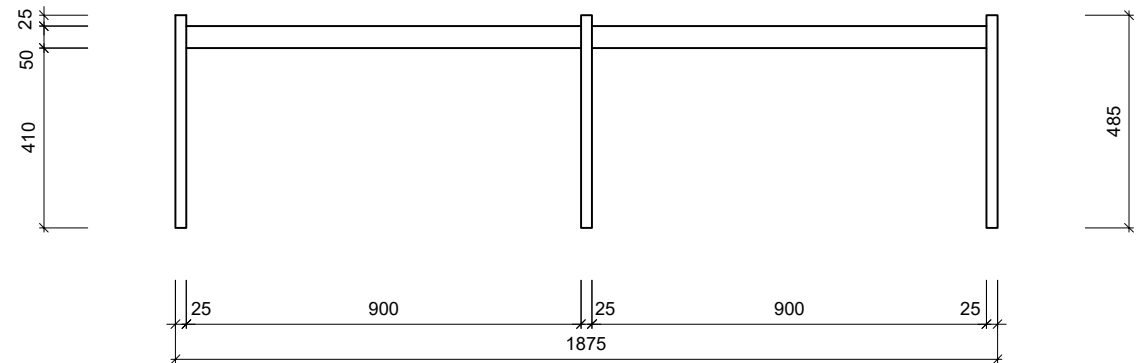

Product depth 375 mm

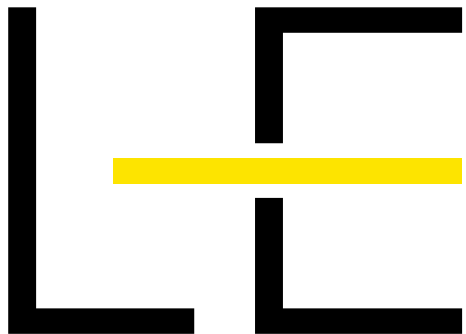

Contact:

Ing. Jitka Vaněčková, CEO

jitka@lerroa.com, tel.: +420 775 845 468

obchod@lerroa.com



@lerroa.cz

